

threaded CAPS



CD Series

Applicable Specs.: MIL-C-52078, MIL-C-5501/3, MIL-C-5501/11, (NAS-814), NAS-832

Caplug No.	Dimensions					Packaging				Caplug No.
	To Fit Tube Size	To Fit Thread Size	A		No. of Ribs	Standard Carton		Mini Pak Quantity		
			in	mm		Shipping Wt. (Approx.)				
					lbs	kgs	No. of Pieces			
CD-2	-	1/4-36	.22	5.55	4	4	1.8	5000	1000	CD-2
CD-3	3/16	3/8-24	.47	11.94	4	7	3.1	5000	1000	CD-3
CD-4	1/4	7/16-20	.47	11.94	4	7	3.1	5000	1000	CD-4
CD-41	1/4	7/16-24	.30	7.62	4	5	2.2	5000	1000	CD-41
CD-5	5/16	1/2-20	.47	11.94	6	9	4.0	5000	1000	CD-5
CD-6	3/8	9/16-18	.53	13.46	6	10	4.5	5000	1000	CD-6
CD-6A	3/8	5/8-18	.53	13.46	6	12	5.4	5000	1000	CD-6A
CD-66	3/8	5/8-18	.41	10.41	6	10	4.5	5000	1000	CD-66
CD-67	-	5/8-24	.41	10.41	6	8	3.6	5000	1000	CD-67
CD-8	1/2	3/4-16	.57	14.48	6	15	6.8	5000	1000	CD-8
CD-82	-	3/4-20	.50	12.70	6	13	5.8	5000	1000	CD-82
CD-10	5/8	7/8-14	.68	17.27	6	20	9.0	5000	1000	CD-10
CD-101	5/8	7/8-18	.44	11.18	6	15	6.8	5000	1000	CD-101
CD-11	-	1-14	.78	19.81	8	13	5.8	2500	500	CD-11
CD-12	3/4	1 1/16-12	.75	19.05	8	17	7.6	2500	500	CD-12
CD-12A	3/4	1 1/16-14	.75	19.05	8	15	6.8	2500	500	CD-12A
CD-130	-	1 1/8-18	.50	12.70	8	11	4.9	2500	500	CD-130
CD-14	7/8	1 3/16-12	.94	23.88	6	19	8.6	2500	500	CD-14
CD-150	-	1 1/4-18	.50	12.70	8	13	5.8	2500	500	CD-150
CD-16	1	1 5/16-12	.84	21.34	8	11	4.9	1000	200	CD-16
CD-170	1	1 3/8-18	.50	12.70	8	15	6.8	2500	500	CD-170
CD-18	-	1 1/2-12	.75	19.05	8	13	5.8	1000	200	CD-18
CD-20	1 1/4	1 5/8-12	.91	23.11	8	12	5.4	1000	200	CD-20
CD-22	-	1 3/4-12	.94	23.88	8	11	4.9	1000	200	CD-22
CD-24	1 1/2	1 7/8-12	1.00	25.40	8	14	6.3	1000	200	CD-24
CD-400	-	3-12	1.16	29.47	12	12	5.4	250	50	CD-400

ASC Series

Applicable Specs.: MIL-C-5501/3, NAS-817, NAS-835

Caplug No.	Dimensions						Packaging				Caplug No.
	To Fit Tube Size	To Fit Thread Size	A		B		Standard Carton		Mini Pak Quantity		
			in	mm	in	mm	Shipping Wt. (Approx.)				
							lbs	kgs	No. of Pieces		
ASC-2	1/8	5/16-24	.42	10.67	.33	9.65	5	2.2	5000	1000	ASC-2
ASC-3	3/16	3/8-24	.36	9.14	.30	7.62	6	2.7	5000	1000	ASC-3
ASC-4	1/4	7/16-20	.54	13.72	.46	11.68	9	4.0	5000	1000	ASC-4
ASC-5	5/16	1/2-20	.52	13.21	.43	10.92	9	4.0	5000	1000	ASC-5
ASC-6	3/8	9/16-18	.54	13.72	.46	11.68	14	6.3	6000	1000	ASC-6
ASC-7	7/16	5/8-18	.61	15.49	.52	13.21	15	6.8	5000	1000	ASC-7
ASC-8	1/2	3/4-16	.64	16.26	.55	13.97	23	10.3	6000	1000	ASC-8
ASC-10	5/8	7/8-14	.74	18.80	.65	16.51	13	5.8	3700	500	ASC-10
ASC-12	3/4	1 1/16-12	.85	21.59	.76	19.30	18	8.1	2200	500	ASC-12
ASC-16	1	1 5/16-12	.86	21.84	.76	19.30	13	5.8	1400	200	ASC-16
ASC-20	1 1/4	1 5/8-12	.87	22.22	.71	18.25	12	5.4	950	190	ASC-20



CAPS threaded

PC Series Plastic Threaded Caps for Pipe Ends

EXPANDED



Heavy wall polyethylene Series PC Caps ensure protection for threaded pipe ends. Extra length provides sealing on pipe surface beyond last thread. These caps not only protect the NPT threads from damage during handling and storage, but they also prevent moisture, debris and rodents from entering the pipe.



MATERIAL: Low Density Polyethylene
COLOR*: as shown in spec table

PC-3/8 thru PC-2

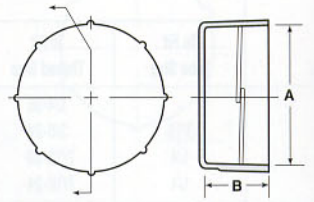

PC-6, -8 have ribbing
PC-3, -3 1/2, -4, -5, -10, -12, are smooth
Built-in thin membrane for optional venting

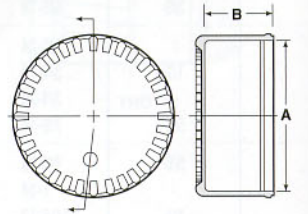



PC Series

Caplug No.	To Fit Thread Size	Dimensions				Color	Packaging			Mini Pak Quantity	Caplug No.
		A		B			Standard Carton				
		in	mm	in	mm		Shipping Wt. (Approx.)				
lbs	kgs	No. of Pieces									
PC-3/8 (602)	3/8 NPT	.68	17.27	.50	12.70	Black	9	4.0	5000	1000	PC-3/8 (602)
PC-1/2 (603)	1/2 NPT	.84	21.34	.87	22.10	Black	21	9.4	2500	500	PC-1/2 (603)
PC-3/4 (604)	3/4 NPT	1.05	26.67	.91	23.11	Black	13	5.8	2500	500	PC-3/4 (604)
PC-1 (605)	1 NPT	1.32	33.53	1.05	26.67	Black	13	5.8	1000	200	PC-1 (605)
PC-1 1/4 (606)	1 1/4 NPT	1.66	42.17	1.05	26.67	Black	18	8.1	1000	200	PC-1 1/4 (606)
PC-1 1/2 (607)	1 1/2 NPT	1.90	48.26	1.07	27.18	Black	11	4.9	500	100	PC-1 1/2 (607)
PC-2 (608)	2 NPT	2.38	60.45	1.09	27.69	Black	15	6.8	500	100	PC-2 (608)
PC-3	3 NPT	3.50	88.90	2.00	50.80	Black	25	11.2	300	60	PC-3
PC-3 1/2	3 1/2 NPT	4.02	102.00	2.34	59.44	Black	25	11.3	150	N/A	PC-3 1/2
PC-4	4 NPT	4.50	114.30	2.10	53.34	Black	24	10.8	150	N/A	PC-4
PC-5	5 NPT	5.56	141.23	2.21	56.14	Black	23	10.3	100	N/A	PC-5
PC-6	6 NPT	6.62	168.15	2.32	58.93	Black	18	8.1	60	N/A	PC-6
PC-8	8 NPT	8.62	218.96	2.50	63.50	Black	18	8.1	35	N/A	PC-8
PC-10	10 NPT	10.75	273.06	2.80	71.12	Blue	18	8.1	40	N/A	PC-10
PC-12	12 NPT	12.88	327.16	2.53	64.26	Blue	22	9.9	25	N/A	PC-12



PLUGS non-threaded

T Series Tapered Plugs

Tapered Plugs are tapered in design and made from highly pliable (or flexible) polyethylene.

Not only can they be applied to fit snugly, but they can also be easily removed. Especially recommended for use on MIL Std. and SAE-type tube and hydraulic fittings and for threaded external and internal NPT fittings.

Popular size Tapered Plugs are stocked also in green FlexTemp, a flexible thermoplastic rubber for extreme temperature applications ranging from -90° F to 300° F (-68°C to 149°C).

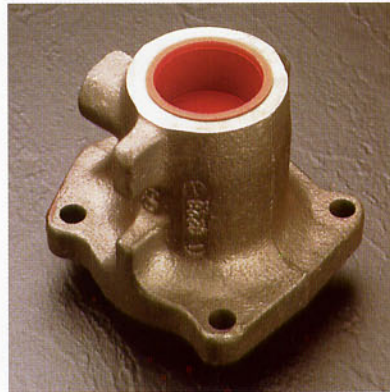
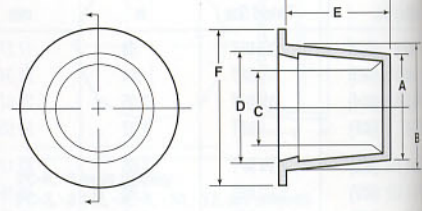

MATERIAL: Low Density Polyethylene
COLOR*: Red



T Series

Applicable Specs.: MIL-C-5501/7 (MIL-C-52078), NAS-834

Selection Charts

Recommended closures for tube and hydraulic fittings**



Caplug No.	Fitting Size (Dash No.)	Outside Diameter	Thread Size	Caplug No.
T-1	-2	1/8	5/16 - 24	T-1
T-2	-3	3/16	3/8 - 24	T-2
T-3	-4	1/4	7/16 - 20	T-3
T-4	-5	5/16	1/2 - 20	T-4
T-5	-6	3/8	9/16 - 18	T-5
T-6	-	3/8	5/8 - 18	T-6
T-8	-8	1/2	3/4 - 16	T-8
T-10	-10	5/8	7/8 - 14	T-10
T-12X	-12	3/4	1 1/16 - 12	T-12X
T-14X	-16	1	1 5/16 - 12	T-14X
T-17-S	-20	1 1/4	1 5/8 - 12	T-17-S
T-19	-24	1 1/2	1 7/8 - 12	T-19
T-221	-28	1 3/4	2 1/4 - 12	T-221
T-240	-32	2	2 1/2 - 12	T-240

Recommended closures for threaded internal NPT fittings***

Based on average tapped hole fit. It is suggested that sample Plugs be tried for size before ordering in quantity.

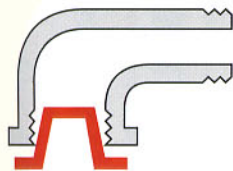

Caplug No.	NPT Size	Caplug No.
T-2X	1/8	T-2X
T-4	1/4	T-4
T-6X	3/8	T-6X
T-9	1/2	T-9
T-12X	3/4	T-12X
T-14	1	T-14
T-17-S	1 1/4	T-17-S
T-20-S	1 1/2	T-20-S
T-24-S	2	T-24-S
T-44	2 1/2	T-44
T-501	3	T-501
T-502	3 1/2	T-502
T-1070	4	T-1070
T-1086	5	T-1086
T-1103	6	T-1103

Recommended closures for unthreaded standard weight pipe**



Caplug No.	Size	Caplug No.
T-1	1/8	T-1
T-2X	1/4	T-2X
T-5	3/8	T-5
T-7	1/2	T-7
T-10	3/4	T-10
T-13	1	T-13
T-16	1 1/4	T-16
T-18	1 1/2	T-18
T-220	2	T-220
T-250	2 1/2	T-250
T-53	3	T-53
T-1050	3 1/2	T-1050
T-1064	4	T-1064
T-1080	6	T-1080
T-1097	8	T-1097

**For other tapered style plugs see:

Series	Pages
WW	84-85
W	86-87
WWX	86-87
SRP	94-95
PTP	88-89
L	90-91
CPT	90-91
VTP	104-105
TP	104-105

***For threaded plugs see:

Series	Pages	Series	Pages
PDF	110-111	PDI	108-109
AFO	112-113	ADP	112-113
PD	110-111	PDO	108-109
ASP	112-113	PDE	108-109
RP	114-115	P	106-107
MSP	110-111	RPO	114-115
BSP	112-113	RPO-M	114-115